



DC 1800<sup>UL</sup>

---

Original instructions

Part No 94567



**WARNING!**

Read the instruction manual before using the machine.

Dustcontrol reserves the right to change specifications without notice and is under no obligation to alter previously delivered products. Dustcontrol is not responsible for errors or omissions in this user instruction.

**Manufactured by:**

Dustcontrol AB  
Box 3088, Kumla Gårdsväg 14  
SE-145 03 Norsborg  
Tel: + 46 8 531 940 00  
support@dustcontrol.se  
www.dustcontrol.com

**Sold by:**

# Contents

Safety Considerations _____	4-5	Warranty _____	9
Technical Data _____	6	Trouble Shooting _____	9
Description _____	6	Spare parts _____	10
Operation _____	7	EC-declaration _____	11
Service _____	8	Dustcontrol Worldwide _____	12
Accessories _____	9		

# Safety Considerations

Read all instructions before attempting to operate this machine.

If not this safety consideration follows the guarantee is not valid and personal injury and machine damage can be caused.

**WARNING!** When using electric machines, basic safety precautions should always be followed to reduce the risk of fire, electric shock and personal injury, including the following:

## 1. Important!

No hot particles nor ignition sources are allowed to be sucked into the unit. The machine should not be used for explosives, unstable or pyrophoric particles.

- Operators shall be adequately instructed on the use of these machines.

- Do not leave appliance when plugged in. Unplug from outlet when not in use and before servicing.

- Do not allow to be used as a toy. Close attention is necessary when used by or near children.

- Do not unplug by pulling on cord. To unplug, grasp the plug, not the cord.

- Do not handle plug or appliance with wet hands.

- Do not put any object into openings. Do not use with any opening blocked; keep free of dust, lint, hair, and anything that may reduce air flow.

- Keep hair, loose clothing, fingers.

- Turn off all controls before unplugging.

- Use extra care when cleaning on stairs.

- Connect to a properly grounded outlet only. See Grounding Instructions.

- "Do not use without dust bag and/or filters in place."

- To Reduce the Risk of Electric Shock – Do Not Use Outdoors or on Wet Surfaces"

- To Reduce the Risk of Electric Shock- Unplug Before Cleaning or Servicing"

- This machine is for dry use only.

– **CAUTION!** To Reduce the Risk of Injury From Moving Parts – Unplug Before Servicing"

– **CAUTION!** This machine is for indoor use only.

– **CAUTION!** This machine shall be stored indoors only.

## 2. Work area environment

Don't expose the machine for rain. Don't use it in damp or wet locations or in presence of flammable liquids or gases.

## 3. Overload

Never let the machine operate fully throttled. Always follow the regulations pertinent to the material you are working with ie asbestos. Don't use the machine for purposes that it isn't intended for.

## 4. Body injuries

Never let the suction come in contact with parts of the body. The strong suction effect can hurt the blood-vessels in the skin. Don't repair the electric components yourself. The machine should be serviced by qualified personnel only. Faults may cause injury. See also below under warnings.

## 5. Don't abuse cord

Never pull the machine by the cord. Keep the cord from heat and sharp edges. Check the electric cable regularly for damage.

## 6. Important measure

With cleaning and maintenance on the machine, the power cable should be dis-connected from the supply. The machine must not be washed or cleaned with water.

## 7. Maintain the machine with care

Keep the machine clean and check that the hose is undamaged and that all gaskets are tight. Follow instructions. Keep handles dry and free from oil and grease.

# Safety Considerations

## 8. Checking for damage

Before further use of the machine it should be carefully checked that the machine is undamaged. If appliance is not working as it should, has been dropped, damaged, left outdoors, or dropped into water, return it to a service center. Use cord as a handle, close a door on cord. Do not run appliance over cord. If there are any damaged parts these should be repaired by a Dustcontrol authorized service center.

If the supply cord is damaged, it must be replaced by the manufacturer, its service agent or similarly qualified persons in order to avoid a hazard.

## SAVE THESE INSTRUCTIONS.

This machine is intended for commercial use only, for example in hotels, schools, hospitals, factories, shops, offices and rental businesses.

## 10. Grounding Instructions

This appliance must be grounded. If it should malfunction or breakdown, grounding provides a path of least resistance for electric current to reduce the risk of electric shock. This appliance is equipped with a cord having an equipment-grounding conductor and grounding plug. The plug must be inserted into an appropriate outlet that is properly installed and grounded in accordance with all local codes and ordinances.

## 9. Warning

Use only accessories and replaceable parts which are available in the Dustcontrol catalogue. Note! If you use wrong spare parts (filter and collection sacks) the machine can leak hazardous dust which can cause personal injury. The handle on the top of the machine can only be used by manual power and empty container. The machine is constructed for a maximal total weight of 40 Kg. Higher loading can cause damage.

This appliance is not intended for use by persons (including children) with reduced physical, sensory or mental capabilities, or lack of experience and knowledge, unless they have been given supervision or instruction concerning use of the appliance by a person responsible for their safety. Children should be supervised to ensure that they do not play with the appliance.

**WARNING** - Improper connection of the equipment-grounding conductor can result in a risk of electric shock. Check with a qualified electrician or service person if you are in doubt as to whether the outlet is properly grounded. Do not modify the plug provided with the appliance - if it will not fit the outlet, have a proper outlet installed by a qualified electrician.

This appliance is for use on a nominal 120-V circuit and has a grounding attachment plug that looks like the plug illustrated in sketch A in Figure 20. Make sure that the appliance is connected to an outlet having the same configuration as the plug. No adaptor should be used with this appliance.

# Technical Data

	<b>DC 1800</b>	<b>DC 1800 XL</b>
HxWxL	780x402x382 mm	1225x402x382 mm
Weight	15 kg	19 kg
Inlet	X 50 mm	X 50 mm
Hose length Ø 50	5 m	5 m
Collection container	15 l	60 l
Flow, max	190 m <sup>3</sup> /h	190 m <sup>3</sup> /h
Neg. pressure max	24 kPa	24 kPa
Power consumption	1340 W (120 V)	1340 W (120 V)
Auto: Power consumption connected tool */min 200 W		
Fine filter polyester, area	1.5 m <sup>2</sup>	1.5 m <sup>2</sup>
Degree of separation fine filter, (EN 60335-2-69, Class M)	99.9 %	99.9 %
Filter area micro filter	0.85 m <sup>2</sup>	0.85 m <sup>2</sup>
Degree of separation micro filter, (EN 60335-2-69, Class H)	99.995 %	99.995 %
(EN 1822-1)	HEPA H13	HEPA H13
Sound level	< 68 dB(A)	< 68 dB(A)

## Description

The machine should be used for suction and separation of dried dust. The machine fulfil the demands for separation of unhealthy dust.

The DC 1800 is, despite it's compact size, a full capacity Dustcontrol machine. It is stable, tough and reliable and particularly suited to spot extraction in many different applications ie: welding, grinding, sanding and cleanup with the 38 mm program. Dust separation is in any case as efficient as with the larger Dustcontrol machines.

The design is ergonomic and appealing. With a very low sound level of 68 dB(A) at 1m distance, the DC 1800 is suitable for use in areas which are sensitive to noise. The direct drive two stage high pressure fan is integrated into the units top. The 1400 W capacity fan is double insulated for higher safety.

# Operation

**DC 1800:** Connect the unit to a suitable power source, note requirements on the ID plate. If an extension cord is to be used, only waterproof cords are acceptable.

The DC 1800 is equipped with a filter indication lamp that indicates when the filter needs cleaning or changing. The filter is generally cleaned once or twice daily during normal continuous operation. The unit must be in operation to perform filter cleaning. Loosen the tube from the suction pipe and press the plastic cage against the black stop head on the exhaust channel so that maximum pressure is created in the cyclone.

Open the port on the side of the unit three to six times. This reverse pulse of air cleans the filter.

The machine can be used both with or without collection sack.

The collection sack should only be changed after the cleaning of the filters. The collection sack must be tied off when it is removed from the container. Use only original Dustcontrol spare parts. There should not be any fold on the container border. The tightness make that the sac does not being sucked.

When remounting the motor top and the cyclone on the container the hose inlet should be pointed according to the picture beside.

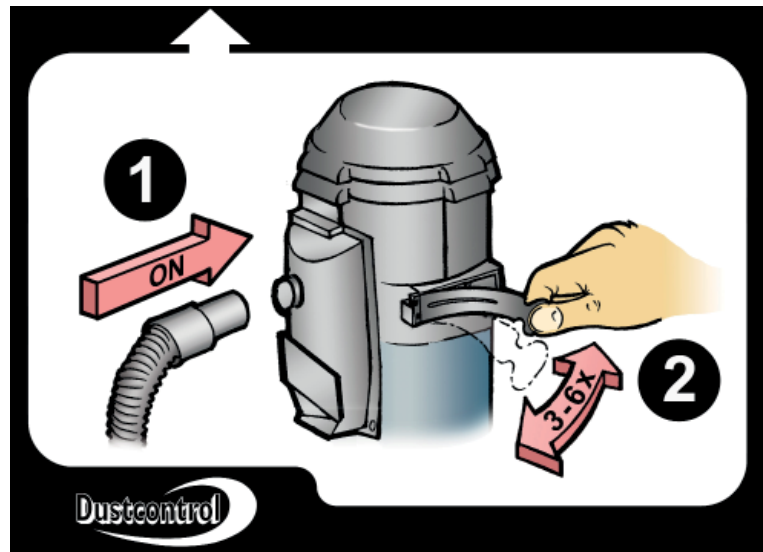

For best result:

- Secure that no air is between the bag and the barrel when you apply the bag.
- Secure that no air is leaking between the bag and the barrel when you are using the machine.

# Service

During cleaning and service of the unit, the unit should be disconnected from the power supply.

The fine filter should be changed at least once per year. Use only original parts for replacement. If the unit is equipped with a HEPA filter, this filter should be changed every 300 working hours. Use breathing protection and perform this operation in a contained area. The used filter should be placed in containment and disposed of in the proper and prescribed method.

## Filter change:

Remove the motor head. Lift the filter straight up out of the cyclone. When required, a plastic sack can be placed over the cyclone for dust-free filter change. The filter is lifted directly into the bag.

During the filter change, check the filter gasket. A damaged gasket can allow the release of hazardous dust. Never use old gaskets or after-market filters. Use only genuine Dustcontrol spare parts to maintain the unit for use on hazardous dusts.

Check regularly that the electrical cable is not damaged. The DC 1800 should be performance tested at least once per year because it may be used with hazardous materials. Worn parts must be replaced.

For vacuum motor the typical average life of the original brushes is 600 - 700 hours. They can then be exchanged or complete motor/fan replaced.

For 2nd brush set life is ca. 400 hours and for 3rd brush set ca. 300 hours. After that the commutator is worn out and the motor needs to be replaced.

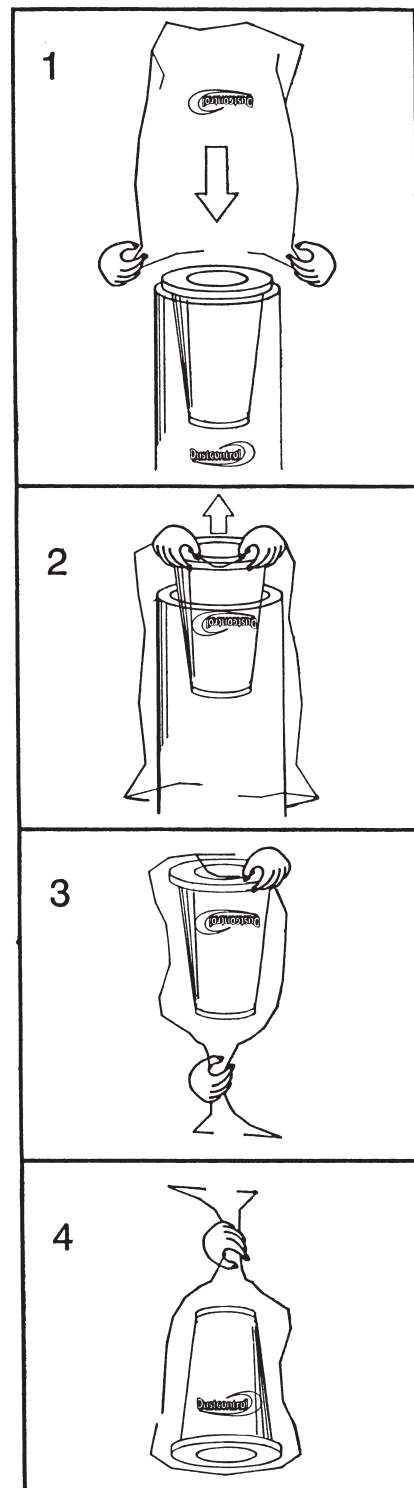



# Accessories

Description	Part No	Description	Part No
Collection sack, standard	42291	HEPA-filter	42027
Fine filter, cellulosa with integrated filter cover	42029	Basket for plastic bag	42369
Fine filter, polyester with integrated filter cover	42028	Other accessories, see Dustcontrol catalogue.	

# Warranty

The warranty period for this machine is two years and covers manufacturers faults. The warranty is valid under the condition that the machine is used under normal conditions on the task for which it was designed and is maintained properly.

Normal wear is not covered by this warranty. Service performed by other than Dustcontrol or its authorized agent voids automatically the warranty. No other warranty express or implied is applicable.

# Trouble Shooting

Problem	Fault	Solution
Motor will not start.	Machine not connected	Make sure connection.
The motor stops directly after starting.	Incorrect fuse.	Change to correct circuit.
Fan runs but no suction.	Hose not connected. Hose plugged.	Connect the hose. Find and remove block
Fan runs but poor suction.	Hole in the hose. Plugged filter. Hose too long or too small. Hose is kinked. Machine top is mounted incorrectly. Dust is packed in the cyclone.	Change or repair hose. Clean or change filter. Change the hose. Check and free. Adjust the mounting. Take off the top and clean out.
Machine blows dust.	Filter is perforated or has come loose.	Check the filters and change if necessary.
Abnormal sound from machine.		Order service.

# Spare Parts

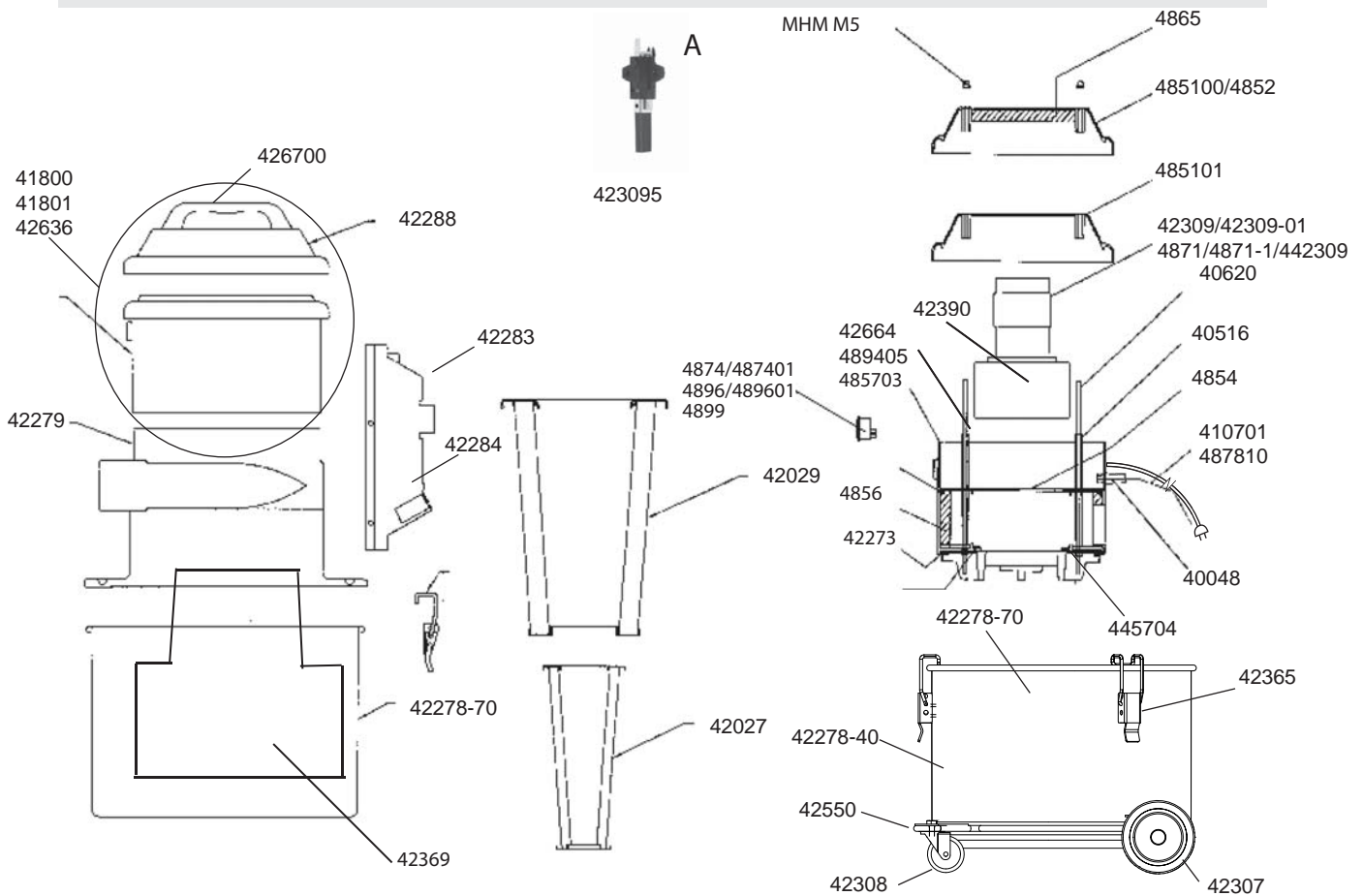

## Part No Description

40048	Bend protector
40516	Spacer
423095	Brush mechanism eco-motor 230 V 1285 W
410701	Cable
42027	HEPA filter
42029	Fine filter, cellulose
42273	Gasket
42278-40	Container
42278-70	Container, incl cart container and fastener
42279	Cyklone
42283	Outlet housing with absorbent
42284	Sound absorbent
42288	Handle and cover
42307	Wheel
42308	Caster
42309	Motor 1400 W, 230 V
42309-01	Motor, eco, 1285 W 230 V
42315	Axle cap
41800	Fan housing eco 1285 W
42365	Fastener
42369	Basket for plastic bag
42390	Gasket motor 42309
42549	Wheel attachment, behind



94567

## Part No Description

42550	Cart container
42636	Fan housing, 230 V 50 Hz
41801	Fan housing Auto, eco 1285 W
42664	Circuit card 230 V
426700	Handle
42716	Cart container complete
442309	Omybyggnadskit, eco-motor 230 V EU
445704	Gasket
485100	Solid cover
485101	Cover with hole
4852	Cover air filter
4854	Plate
4856	Sound absorbent for 485702
485703	Motor housing, auto
4865	Sound absorbent for

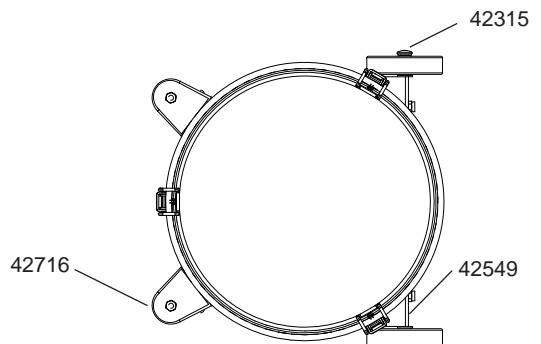

English

## Part No Description

485100	Motor 1200 W, 115 V
4871	Motor 1340 W, 120 V
4871-1	Motor 1340 W, 120 V
4874	Switch
487401	Switch 8 A
487810	Cable, standard
4896	Switch autostart
489601	Switch autostart 8 A
4899	Protection cap
489405	Circuit card 115 V
94567	Original instructions DC 1800 UL

## EC-declaration of conformity

We declare that DC 1800 UL is in conformity with following directives and standards;  
2006/42/EC, 2014/35/EU, 2014/30/EU, EN 60204-1, EN 1822-1.

Serial Number and manufacturing year are indicated in a rating plate on the machine.

Dustcontrol AB



Peter Söderling  
Technical Manager

# DUSTCONTROL WORLDWIDE

## Dustcontrol AB

Box 3088  
Kumla Gårdsväg 14  
SE-145 03 Norsborg  
Tel: +46 8 531 940 00  
Fax: +46 8 531 703 05  
support@dustcontrol.se  
www.dustcontrol.com

## AT

### Dustcontrol Ges.m.b.H.

Tel: +43 316 428 081  
info@dustcontrol.at  
www.dustcontrol.at

## AU

### Archquip - All Preparation Equipment

Tel: +61 7 3217 9877  
www.allpreparationequip-  
ment.com.au

## BENELUX

### Dustsolutions B.V.

Tel: +31(0)38-2020154  
sales@dustsolutions.nl  
www.dustsolutions.nl

## BG

### Metaltech14 Ltd

Tel: +359 888 255 102,  
+359 889 999 593  
metaltex14@abv.bg  
www.dustcontrolbg.com

## CA

### Dustcontrol Canada Inc.

Tel: +1 877 844 8784  
info@dustcontrol.ca  
www.dustcontrol.ca

## CH

### Rosset Technik Maschinen Werkzeuge AG

Tel: +41 41 462 50 70  
info@rosset-technik.ch  
www.rosset-technik.ch

## CN

### Suzhou DustCollect Filtration Technology Co., Ltd.

Tel: +86 180 6800 0359  
sale@dustcollect.cn  
www.dustcollect.cn

## DE

### Dustcontrol GmbH

Tel: +49 70 32-97 56 0  
info@dustcontrol.de  
www.dustcontrol.de

## DK

### Erenfred Pedersen A/S - Construction

Tel: +45 98 13 77 22  
info@ep.dk  
www.ep.dk

### Dansk Procesventilation ApS - Industry

Tel: +45 61 270 870  
info@dansk-procesventilation.dk  
www.dansk-procesventilation.dk

## EE

### G-Color Baltic OÜ

Tel: +372 682 5919  
sales@g-color.ee  
www.g-color.ee

## ES

### Barin, s.a.

Tel: +34 91 6281428  
info@barin.es  
www.barin.es

## FI

### Dustcontrol FIN OY

Tel: +358 9-682 4330  
dc@dustcontrol.fi  
www.dustcontrol.fi

## FR

### SMH Equipements-Construction

Tel: +33 (0)2 37 26 00 25  
info@abequipements.com  
www.smhequipements.com

### Dustcontrol AB France- Industry

Tel: +46 8 53194016  
hk@dustcontrol.se  
www.dustcontrol.com

## HU

### Vandras Kft

Tel: +36-1-427-0322  
Mobile: +36-20-9310-349  
vandras@t-online.hu  
www.vandras.hu

## IN

### Advance Ventilation Pvt. Limited

Tel: +91 11 47243296-298  
sales@advanceventilation.com  
www.advanceventilation.com

## IR

### BioMedoc International Group

Tel: +44 161 820 8441  
info@biomedoc.com  
www.biomedoc.com

## IT

### Airum srl

Tel: +39 (0)516 025 072  
info@airum.com  
www.airum.com

## KR

### E. S. H Engineering Co.

Tel: +82 (0)2 466 7966  
k.u.lee@hanmail.net  
www.esheng.co.kr

## LT

### UAB Hidromega

Tel: +370 677 10254  
info@hidromega.lt  
www.hidromega.lt

## LV

### SIA Reaktivs

Tel: +371 20282200  
reaktivs@reaktivs.lv  
www.reaktivs.lv

## MY, ID

### Blondal Stada (M) Sdn. Bhd.

Tel: +603 5569 1006  
info@stada.com.my  
www.stada.com.my

## NO

### Teijo Norge A.S

Tel: +47 3222 6565  
firmapost@teijo.no  
www.teijo.no

## PE

### Efixo

Tel: (00511) 583-8541  
Cel: (0051) 968-140-066  
contacto@efixo.pe  
http://www.efixo.pe

## PH

### Sweden Concrete Machines Philippines Inc.

Tel: +63 917 573 1583  
peringe@packoskick.se  
www.swedenconcretemachines.ph

## PL

### Bart Sp. z. o.o.

Tel: +48 32 256 22 33  
info@bart-vent.pl  
www.bart-vent.pl

## PT

### Metec-Mecano Técnica, Lda.

Tel: +351 21 797 02 91  
geral@metec.pt  
www.metec.pt

## RO

### Awselektrotehnik

Tel: +40 771 702 016  
andrei@awstehnik.ro  
www.awstehnik.ro

## RU

### SovPlym Ltd

Tel: +7-812-33-500-33  
mau@sovplym.spb.ru  
www.sovplym.com

## SG

### Blondal (S) Pte Ltd

Tel: +65 6741 7277  
Info@stada.com.my  
www.stada.com.my

## TH

### MCON intertrade Co., Ltd

Tel: +66 (0) 93 935 1442  
thanachote@mconintertrade.com  
www.mconintertrade.com

## TR

### Ventek Mühendislik Ltd

Tel: +90 212 4415596-97  
info@ventek.com.tr  
www.ventek.com.tr

## TW

### Goodland Enterprise Co., Ltd.

Tel: +886-2-3234-0206  
overseas@goodland.com.tw  
www.goodland.com.tw

## UAE

### Global Enterprises Trading Co

Tel: +971-2-555 4733  
global@globalentco.com  
www.globalentco.com

### GEM Industrial Equipment Trading Co

Tel: +971-4-8840 474  
gemuae@eim.ae

## UK

### Dustcontrol UK Ltd.

Tel: +44 1327 858001  
sales@dustcontrol.co.uk  
www.dustcontrol.co.uk

## US

### Dustcontrol Inc.

Tel: +1 910-395-1808  
info@dustcontrolusa.com  
www.dustcontrol.us

www.dustcontrol.com