



DC 2900<sup>UL</sup>

---

Original instructions

Part No 94566



**WARNING!**

Read the instruction manual before using the machine.

Dustcontrol reserves the right to change specifications without notice and is under no obligation to alter previously delivered products. Dustcontrol is not responsible for errors or omissions in this user instruction.

**Manufactured by:**

Dustcontrol AB  
Boc 3088, Kumla Gårdsväg 14  
SE-145 03 Norsborg  
Tel: + 46 8 531 940 00  
support@dustcontrol.se  
www.dustcontrol.com

**Sold by:**

# Contents

Important Safety Instructions _	4-5	Warranty _____	10
Technical Data _____	6	Trouble Shooting _____	10
Description _____	7	Spare Parts _____	11-12
Operation _____	7	EC-declaration _____	13
Service _____	8-9	Dustcontrol Worldwide _____	14
Accessories _____	10	Assembly _____	15

# Important Safety Instructions

Read all instructions before attempting to operate this machine.

**WARNING!** When using electric machines, basic safety precautions should always be followed to reduce the risk of fire, electric shock and personal injury, including the following:

## 1. Important!

No hot particles nor ignition sources are allowed to be sucked into the unit. The machine should not be used for explosives, unstable or pyrophoric particles or dust.

– Operators shall be adequately instructed on the use of these machines.

– Do not leave appliance when plugged in. Unplug from outlet when not in use and before servicing.

– Do not allow to be used as a toy. Close attention is necessary when used by or near children.

– Do not unplug by pulling on cord. To unplug, grasp the plug, not the cord.

– Do not handle plug or appliance with wet hands.

– Do not put any object into openings. Do not use with any opening blocked; keep free of dust, lint, hair, and anything that may reduce air flow.

– Keep hair, loose clothing, fingers.

– Turn off all controls before unplugging.

– Use extra care when cleaning on stairs.

– Connect to a properly grounded outlet only. See Grounding Instructions.

– "Do not use without dust bag and/or filters in place."

– To Reduce the Risk of Electric Shock – Do Not Use Outdoors or on Wet Surfaces"

– To Reduce the Risk of Electric Shock- Unplug Before Cleaning or Servicing"

– This machine is for dry use only.

– **CAUTION!** To Reduce the Risk of Injury From Moving Parts – Unplug Before Servicing"

– **CAUTION!** This machine is for indoor use only.

– **CAUTION!** This machine shall be stored indoors only.

## 2. Work area environment

Don't expose the machine for rain. Don't use it in damp or wet locations or in presence of flammable liquids or gases.

## 3. Overload

Never let the machine operate fully throttled. Always follow the regulations pertinent to the material you are working with ie asbestos. Don't use the machine for purposes that it isn't intended for.

## 4. Body injuries

Never let the suction come in contact with parts of the body. The strong suction effect can hurt the blood-vessels in the skin. Don't repair the electric components yourself. The machine should be serviced by qualified personnel only. Faults may cause injury. See also below under warnings.

## 5. Don't abuse cord

Never pull the machine by the cord. Keep the cord from heat and sharp edges. Check the electric cable regularly for damage.

## 6. Important measure

With cleaning and maintenance on the machine, the power cable should be dis-connected from the supply. The machine must not be washed or cleaned with water.

## 7. Maintain the machine with care

Keep the machine clean and check that the hose is undamaged and that all gaskets are tight. Follow instructions. Keep handles dry and free from oil and grease.

## 8. Checking for damage

Before further use of the machine it should be carefully checked that the machine is undamaged. If appliance is not working as it should,

# Important Safety Instructions

has been dropped, damaged, left outdoors, or dropped into water, return it to a service center. Use cord as a handle, close a door on cord. Do not run appliance over cord. If there are any damaged parts these should be repaired by a Dustcontrol authorized service center.

If the supply cord is damaged, it must be replaced by the manufacturer, its service agent or similarly qualified persons in order to avoid a hazard.

## 9. **Warning**

Use only accessories and replacable parts which are available in the Dustcontrol catalogue.

This appliance is not intended for use by persons (including children) with reduced physical, sensory or mental capabilities, or lack of experience and knowledge, unless they have been given supervision or instruction concerning use of the appliance by a person responsible for their safety. Children should be supervised to ensure that they do not play with the appliance.

## SAVE THESE INSTRUCTIONS!

This machine is intended for commercial use only, for example in hotels, schools, hospitals, factories,shops, offices and rental businesses.

## 10. **Grounding Instructions**

This appliance must be grounded. If it should malfunction or breakdown, grounding provides a path of least resistance for electric current to reduce the risk of electric shock. This appliance is equipped with a cord having an equipment-grounding conductor and grounding plug. The plug must be inserted into an appropriate outlet that is properly installed and grounded in accordance with all local codes and ordinances.

**WARNING** - Improper connection of the equipment-grounding conductor can result in a risk of electric shock. Check with a qualified electrician or service person if you are in doubt as to whether the outlet is properly grounded. Do not modify the plug provided with the appliance - if it will not fit the outlet, have a proper outlet installed by a qualified electrician.

This appliance is for use on a nominal 120-V circuit and has a grounding attachment plug. Make sure that the appliance is connected to an outlet having the same configuration as the plug. No adaptor should be used with this appliance.

# Technical Data

	<b>DC 2900 a</b>	<b>DC 2900c</b>
HxWxL	1145x440x630 mm	1085x440x565 mm
Weight	19 kg	16 kg/35 lbs
Inlet	x 50 mm	x 50 mm
Hose length Ø 50	5 m	5 m
Collection sack/container	40 l	20 l
Flow, max	190 m <sup>3</sup> /h	190 m <sup>3</sup> /h
Neg. pressure max	24 kPa	24 kPa
Power consumption	1340 W (120 V)	1340 W (120 V)
Auto: Power consumption connected tool */min 200 W		
Fine filter polyester, area	1.5 m <sup>2</sup>	1.5 m <sup>2</sup>
Degree of separation fine filter, (EN 60335-2-69, Class M)	99.9 %	99.9 %
Filter area micro filter	0.85 m <sup>2</sup>	0.85 m <sup>2</sup>
Degree of separation micro filter, (EN 60335-2-69, Klass H) (EN 1822-1)	99.995 % HEPA H13	99.995 % HEPA H13
Sound level	< 68 dB(A)	< 68 dB(A)

# Description

The machine should be used for suction and separation of dust. The machine fulfils the demand of separation of unhealthy dust.

The dust extractor is, despite its compact size, a full capacity Dustcontrol machine. It is stable, tough, reliable and particularly suited to spot extraction in many different applications e.g. welding, grinding, sanding and cleanup with the 38 mm program. Dust separation is as efficient as with the larger Dustcontrol machines.

The design is ergonomic and appealing. With a very low sound level of 68 dB(A) at 1 m distance, the

The machine is suitable for use in areas which are sensitive to noise. The direct drive two stage high pressure fan is integrated into the top. The fan is double insulated for higher safety.

# Operation

Connect the unit to a suitable power source, note requirements on the ID plate. If an extension cord is to be used; It must be waterproof.

Man: For manual start of the unit, set the selector switch to the MAN position.

The machine has a filter indicator light that lights up when the flow is approaching 20 m/s (Ø 50) and means that the filter needs to be cleaned or changed. The filter is generally cleaned once or twice daily during normal continuous operation. The unit must be in operation to perform filter cleaning. Loosen the tube from the suction pipe and press the plastic cage against the black stop head on the exhaust channel so that maximum pressure is created in the cyclone. Open the port on the side of the unit three to six times. This reverse pulse of air cleans the filter.

## DC 2900c - plastic bag

The plastic bag should be changed only after the filter is cleaned and when the collected material level is about 5 cm under the foot valve.

Use only original Dustcontrol spare parts.

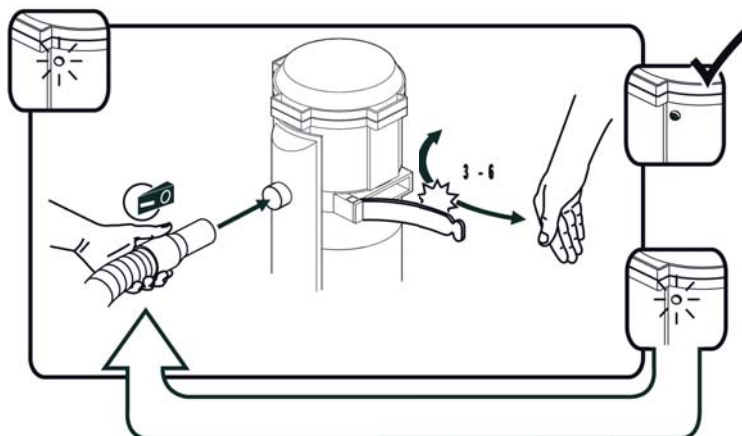

## DC 2900a - container

The container under the cyclone should be emptied when approx. 2/3 full.

# Service

During cleaning and service, the unit should be disconnected from the power supply.

The fine filter should be changed at least once per year. If the machine is used with a microfilter/HEPA filter, this should be changed every 300 running hours. Use breathing protection when changing the filter. Care must be taken during the filter change so as not to expose unprotected persons to harmful dust. Used filters should be sealed in a plastic bag and disposed of properly.

## Filter change:

Remove the motor head. Lift the filter straight up out of the cyclone. When required, a plastic bag can be placed over the cyclone for dust-free filter change. The filter is lifted directly into the bag. During the filter change, check the filter gasket. A damaged gasket can allow the release of hazardous dust. Never use old gaskets or after-market filters. Use only genuine Dustcontrol spare parts to maintain the unit for use with hazardous dusts.

## Change of HEPA filter:

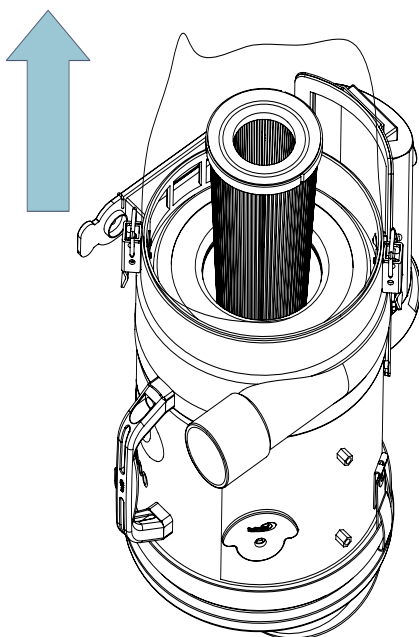

For vacuum motor the average life of the original brushes is 600 - 700 hours. They can then be exchanged or the whole motor/fan can be replaced. For second brush set life is approx. 400 hours and for third brush set ca. 300 hours. Following this the commutator is worn out and the motor needs to be replaced.

## Change of fine filter:

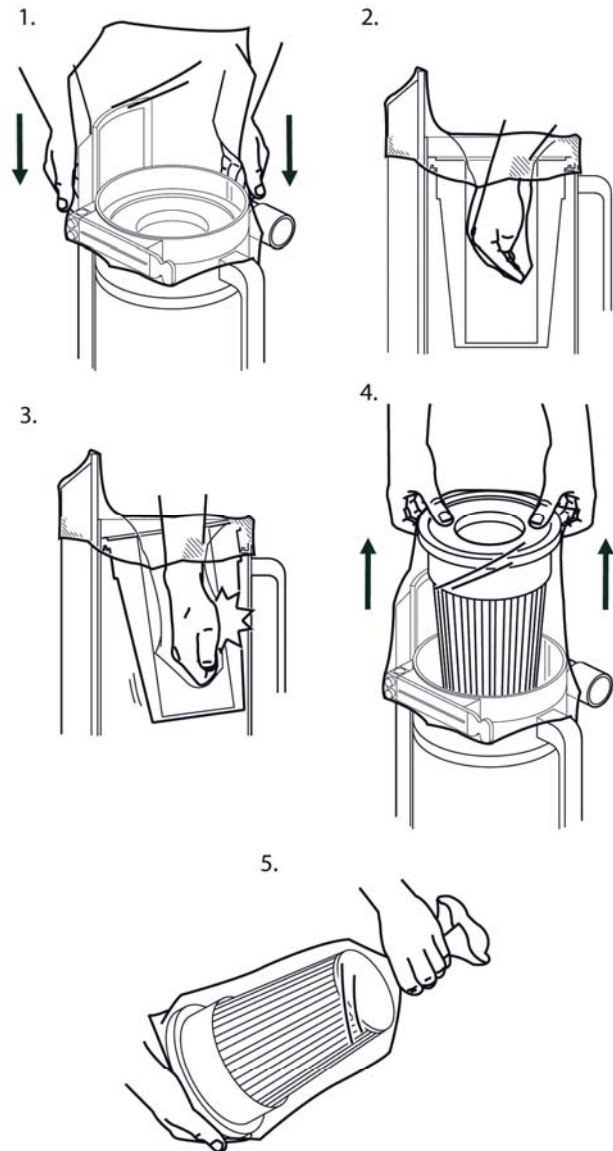



# Service

1



**intelligag;**  
dust free change of bag step by step

**Switch ON**

2

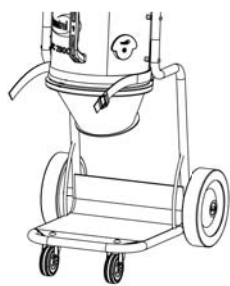

**Switch ON**  
- take out the bag

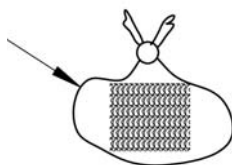

3

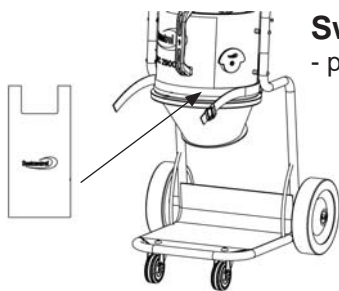

**Switch ON**  
- put the new sack on

4



**Switch ON**  
- pulse the filter and run the dust collector

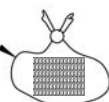

# Accessories

Description	Part no	Description	Part no
Plastic bag, standard	42702	Fine filter, polyester with integrated filter cover	42028
Fine filter, cellulosa with integrated filter cover	42029	Microfilter	42027
Other accessories, see Dustcontrol catalogue.			

# Warranty

The warranty period for this machine is two years and covers manufacturing faults. The warranty is valid only if the machine is used under normal conditions for tasks for which it was designed and is maintained properly.

Normal wear is not covered by this warranty. Service performed by other than Dustcontrol or its authorized agent automatically voids the warranty. No other warranty or implied is applicable.

# Trouble shooting

Problem	Fault	Solution
Motor will not start.	Machine not connected.	Connect machine.
The motor stops directly after starting.	Incorrect fuse.	Change to correct circuit.
Fan runs but no suction.	Hose not connected. Hose plugged.	Connect the hose. Find and remove block.
DC 2900c - plastic bag DC 2900a - container	No plastic bag on the cyclone. The container is not firmly attached to the bottom of the cyclone.	Mount the correct bag. Secure the container.
Fan runs but poor suction.	Hole in the hose. Blocked filter. Hose too long or too small. Hose is kinked. Machine top is mounted incorrectly. Dust is packed in the cyclone.	Change or repair hose. Clean or change filter. Change the hose. Check and free. Adjust the mounting. Take off the top and clean.
Machine blows dust.	Filter is perforated or has come loose.	Check the filters and change if necessary.
Abnormal sound from machine.		Order service.

# Spare Parts

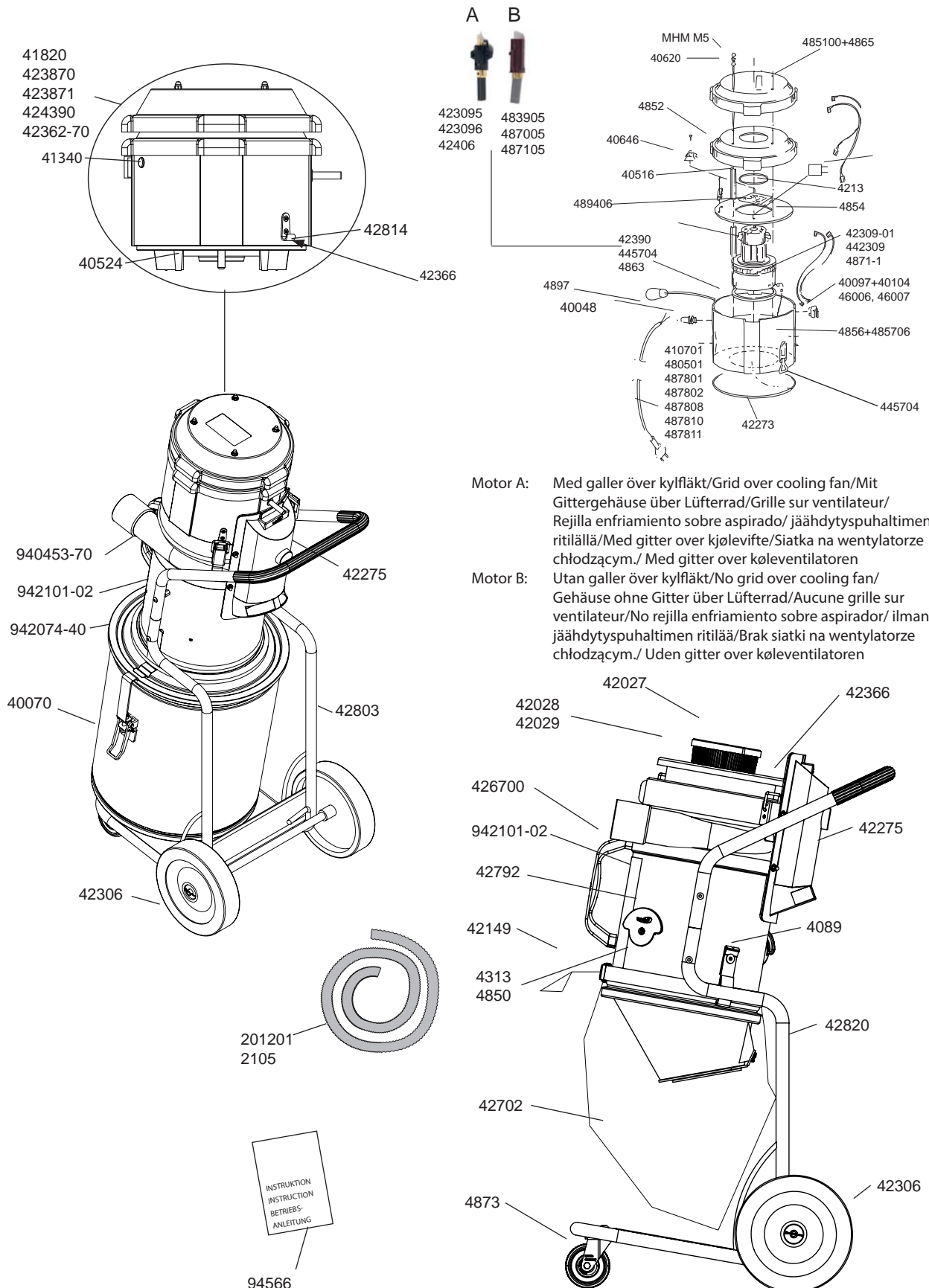

## Spare Parts

*English*

Part No	Description	Part No	Description	Part No	Description
201201	Suction hose 38, swivel connector sleeve, antistatic	423095	230 V Brush mechanism Eco-motor, 1285 W, 230 V	4850	1050 W, 115 V Gasket
2105	Suction hose 38, L=5m	423096	Brush mechanism Eco-motor, 1340 W, 120 V	485100	Solid cover
40048	Bend protector	42362-70	Fan housing 115 V	4852	Cover with hole
40070	Container, 40 l, metal	42366	Fastener	4854	Plate
40097	Switch, 110 V	423870	Fan housing 1285 W	4856	Sound absorbent for 485702
40104	Safety cover switch, 110 V	423871	Fan housing UK, 1285 W, 230 V	485706	Motor housing
40516	Spacer	42390	Gasket for motor 42309	4863	Gasket for motor 4870, 4871
40524	Guiding flange	42406	Brush mechanism 1400 W, 230 V	4865	Sound absorbent for 485100
40620	Retaining bolt	424390	Fan housing auto	487005	Brush mechanism 1200 W, 230 V
40646	Terminal connector	426700	Handle	487105	Brush mechanism, 1200 W, 115 V
410701	Cable Auto, EU	42702	Plastic bag	4871-1	Motor 1340 W, 120 V, 50/60 Hz, UL ECO
41340	Indication light with red lens	42792	Holder bag	4873	Caster
4089	Band holder	42803	Chassis DC 2900a	487802	Cable USA/Can, L=2 m
40097	Switch 115 V	42814	Hitch DC 2900	487808	Cable GB, 115 V
40104	Safety cover switch 115 V	42820	Chassis DC 2900c	487810	Cable, EU
41820	Motor cover USA, 1340 W, 115 V	4313	Strap	487811	Cable GB, 220 V
42027	HEPA filter	442309	Retrofit Kit eco Motor 230 V, 1285 W	489406	Circuit card 230 V
42028	Fine filter, polyester	445704	Gasket	940453-70	Inlet
42029	Fine filter, cellulose	46006	Cable set, motor top STD	94566	Original instructions DC 2900 UL
4213	Sealing moulding	46007	Cable set, motor top AUTO	942074-40	Bottom Lock cyclone
42149	Hose Attachment	480501	Cable L= 6 m (CH)	942101-02	Module mantle
42273	Gasket	483905	Brush mechanism,		
42275	Channel outlets				
42306	Wheelset				
42309-01	Motor, eco, 1285 W,				

## EC-declaration of conformity

We declare that DC 2900 UL is in conformity with following directives and standards;  
2006/42/EC, 2014/35/EU, 2014/30/EU, EN 60204-1, EN 1822-1.

Serial Number and manufacturing year are indicated in a rating plate on the machine.

Dustcontrol AB



Peter Söderling  
Technical Manager

# DUSTCONTROL WORLDWIDE

**Dustcontrol AB**  
Box 3088  
Kumla Gårdsväg 14  
SE-145 03 Norsborg  
Tel: +46 8 531 940 00  
Fax: +46 8 531 703 05  
support@dustcontrol.se  
www.dustcontrol.com

**AT**  
**Dustcontrol Ges.m.b.H.**  
Tel: +43 316 428 081  
info@dustcontrol.at  
www.dustcontrol.at

**AU**  
**Archquip - All Preparation Equipment**  
Tel: +61 7 3217 9877  
www.allpreparationequipment.com.au

**BENELUX**  
**Dustsolutions B.V.**  
Tel: +31(0)38-2020154  
sales@dustsolutions.nl  
www.dustsolutions.nl

**BG**  
**Metaltech14 Ltd**  
Tel: +359 888 255 102,  
+359 889 999 593  
metaltex14@abv.bg  
www.dustcontrolbg.com

**CA**  
**Dustcontrol Canada Inc.**  
Tel: +1 877 844 8784  
info@dustcontrol.ca  
www.dustcontrol.ca

**CH**  
**Rosset Technik Maschinen Werkzeuge AG**  
Tel: +41 41 462 50 70  
info@rosset-technik.ch  
www.rosset-technik.ch

**CN**  
**Suzhou DustCollect Filtration Technology Co., Ltd.**  
Tel: +86 180 6800 0359  
sale@dustcollect.cn  
www.dustcollect.cn

**DE**  
**Dustcontrol GmbH**  
Tel: +49 70 32-97 56 0  
info@dustcontrol.de  
www.dustcontrol.de

**DK**  
**Erenfred Pedersen A/S - Construction**  
Tel +45 98 13 77 22  
info@ep.dk  
www.ep.dk

**Dansk Procesventilation ApS - Industry**  
Tel: +45 61 270 870  
info@dansk-procesventilation.dk  
www.dansk-procesventilation.dk

**EE**  
**G-Color Baltic OÜ**  
Tel: +372 682 5919  
sales@g-color.ee  
www.g-color.ee

**ES**  
**Barin, s.a.**  
Tel: +34 91 6281428  
info@barin.es  
www.barin.es

**FI**  
**Dustcontrol FIN OY**  
Tel: +358 9-682 4330  
dc@dustcontrol.fi  
www.dustcontrol.fi

**FR**  
**SMH Equipements-Construction**  
Tel: +33 (0)2 37 26 00 25  
info@abequipements.com  
www.smhequipements.com

**Dustcontrol AB France- Industry**  
Tel: +46 8 53194016  
hk@dustcontrol.se  
www.dustcontrol.com

**HU**  
**Vandras Kft**  
Tel: +36-1-427-0322  
Mobile: +36-20-9310-349  
vandras@t-online.hu  
www.vandras.hu

**IN**  
**Advance Ventilation Pvt. Limited**  
Tel: +91 11 47243296-298  
sales@advanceventilation.com  
www.advanceventilation.com

**IR**  
**BioMedoc International Group**  
Tel: +44 161 820 8441  
info@biomedoc.com  
www.biomedoc.com

**IT**  
**Airum srl**  
Tel: +39 (0)516 025 072  
info@airum.com  
www.airum.com

**KR**  
**E. S. H Engineering Co.**  
Tel: +82 (0)2 466 7966  
k.u.lee@hanmail.net  
www.esheng.co.kr

**LT**  
**UAB Hidromega**  
Tel: +370 677 10254  
info@hidromega.lt  
www.hidromega.lt

**LV**  
**SIA Reaktivs**  
Tel: +371 20282200  
reaktivs@reaktivs.lv  
www.reaktivs.lv

**MY, ID**  
**Blondal Stada (M) Sdn. Bhd.**  
Tel: +603 5569 1006  
info@stada.com.my  
www.stada.com.my

**NO**  
**Teijo Norge A.S**  
Tel: +47 3222 6565  
firmapost@teijo.no  
www.teijo.no

**NZ**  
**Artizan Diamond Tools**  
Tel: (+64) 03 365 4446  
enquiry@artizandiamond.co.nz  
www.artizandiamond.co.nz

**PE**  
**Efixo**  
Tel: (00511) 583-8541  
Cel: (0051) 968-140-066  
contacto@efixo.pe  
http://www.efixo.pe

**PH**  
**Sweden Concrete Machines Philippines Inc.**  
Tel: +63 917 573 1583  
peringe@packoskick.se  
www.swedenconcretemachines.ph

**PL**  
**Bart Sp. z. o.o.**  
Tel: +48 32 256 22 33  
info@bart-vent.pl  
www.bart-vent.pl

**PT**  
**Metec-Mecano Técnica, Lda.**  
Tel: +351 21 797 02 91  
geral@metec.pt  
www.metec.pt

**RO**  
**AWS Elektrotehnik**  
Tel: +40 0748 288 358  
office@awstehnik.ro  
www.awstehnik.ro

**RU**  
**SovPlym Ltd**  
Tel: +7-812-33-500-33  
mau@sovplym.spb.ru  
www.sovplym.com

**SG**  
**Blondal (S) Pte Ltd**  
Tel: +65 6741 7277  
Info@stada.com.my  
www.stada.com.my

**TH**  
**MCON intertrade Co., Ltd**  
Tel: +66 (0) 93 935 1442  
sales@mconintertrade.com  
www.mconintertrade.com

**TR**  
**Ventek Mühendislik Ltd**  
Tel: +90 212 4415596-97  
info@ventek.com.tr  
www.ventek.com.tr

**TW**  
**Goodland Enterprise Co., Ltd.**  
Tel: +886-2-3234-0206  
sales@goodland.com.tw  
www.goodland.com.tw

**UAE**  
**Global Enterprises Trading Co**  
Tel: +971-2-555 4733  
global@globalentco.com  
www.globalentco.com

**GEM Industrial Equipment Trading Co**  
Tel: +971-4-8840 474  
gemuae@eim.ae

**UK**  
**Dustcontrol UK Ltd.**  
Tel: +44 1327 858001  
sales@dustcontrol.co.uk  
www.dustcontrol.co.uk

**US**  
**Dustcontrol Inc.**  
Tel: +1 910-395-1808  
info@dustcontrolusa.com  
www.dustcontrol.us

[www.dustcontrol.com](http://www.dustcontrol.com)

# DC 2900 Assembly/

1

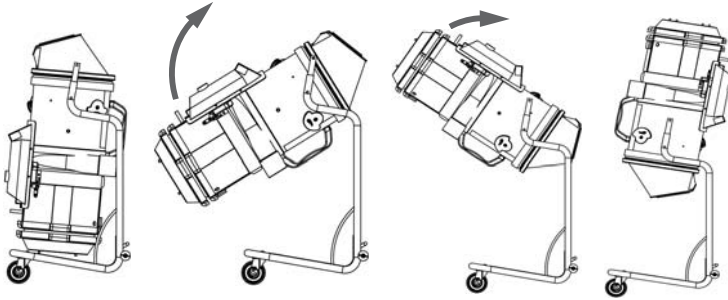

2

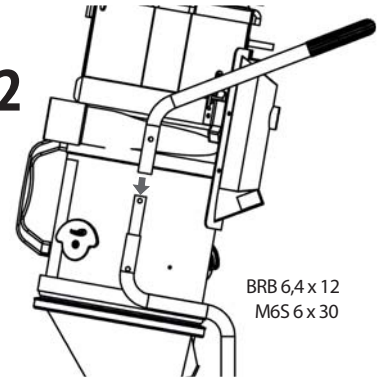

BRB 6,4 x 12  
M6S 6 x 30

3

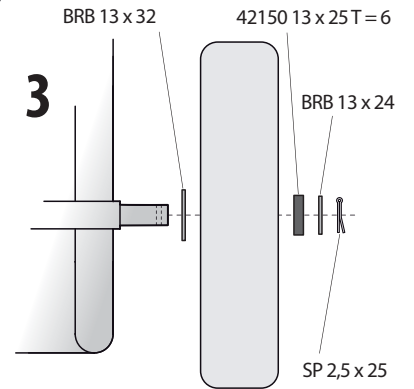

BRB 13 x 32

42150 13 x 25 T=6

BRB 13 x 24

SP 2,5 x 25

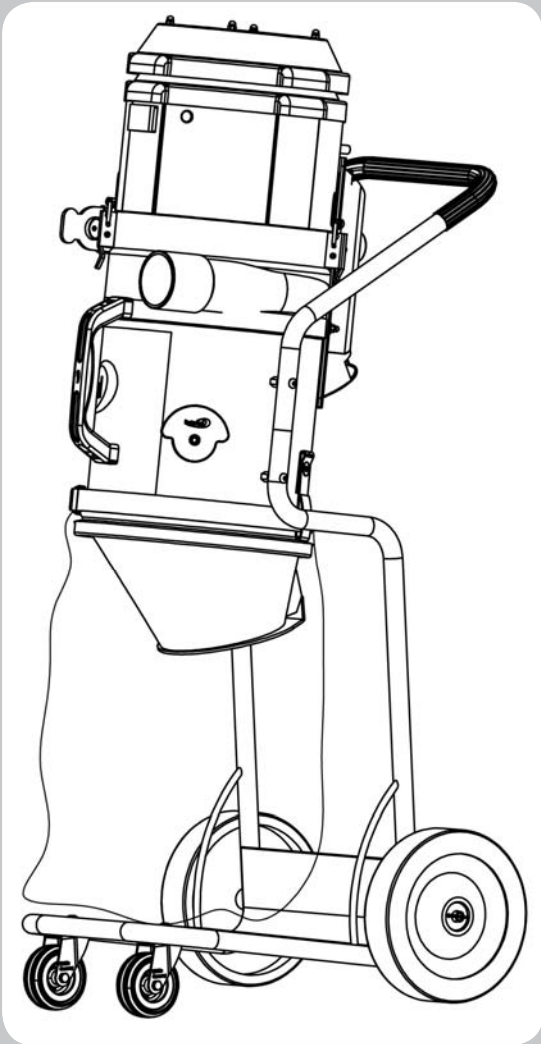

## Contents

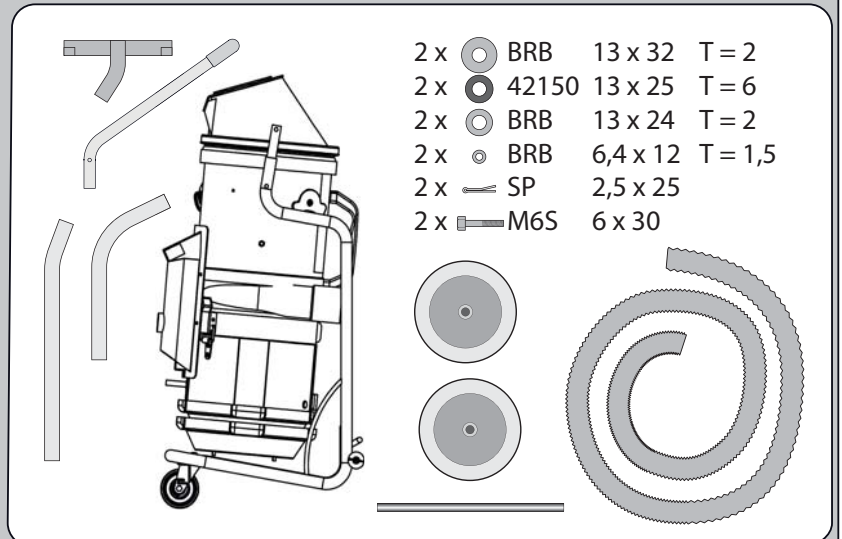

- 2 x BRB 13 x 32 T=2
- 2 x 42150 13 x 25 T=6
- 2 x BRB 13 x 24 T=2
- 2 x BRB 6,4 x 12 T=1,5
- 2 x SP 2,5 x 25
- 2 x M6S 6 x 30

